



18 Richard Howe House Palm Drive

, Rochester, ME1 2EZ

Offers Over £160,000



Virtual tour available . SOUGHT AFTER ROCHESTER ME1 AREA, IDEAL FTB OR INVESTMENT

Discover this charming, 452.08 square feet, single-storey property, perfect for individuals or couples looking for a cozier space. The property hosts a single, well-proportioned bedroom exuding tranquil simplicity. The floor plan is efficiently laid out, featuring an inviting hallway with a convenient storage cupboard and bonus of a full size loft. There is also a kitchen that seamlessly blends into the living/dining area, equipped with an integral oven for meal preparation. Completing the layout is a bathroom, equipped with a tub, promising comforting baths after long days. Externally you will find a communal garden offering space to enjoy the fresh air or dine alfresco style, There is also allocated parking for one car and ample street parking for guests. This compact but functional property, with a single floor layout, subtly ensures a convenient and accessible living experience.

85 years remaining on lease

EPC tbc

COUNCIL TAX BAND B



- communal entrance
- internal hallway
- kitchen
- lounge/diner
- bathroom
- bedroom
- communal garden
- parking

Area Map



Floor Plans

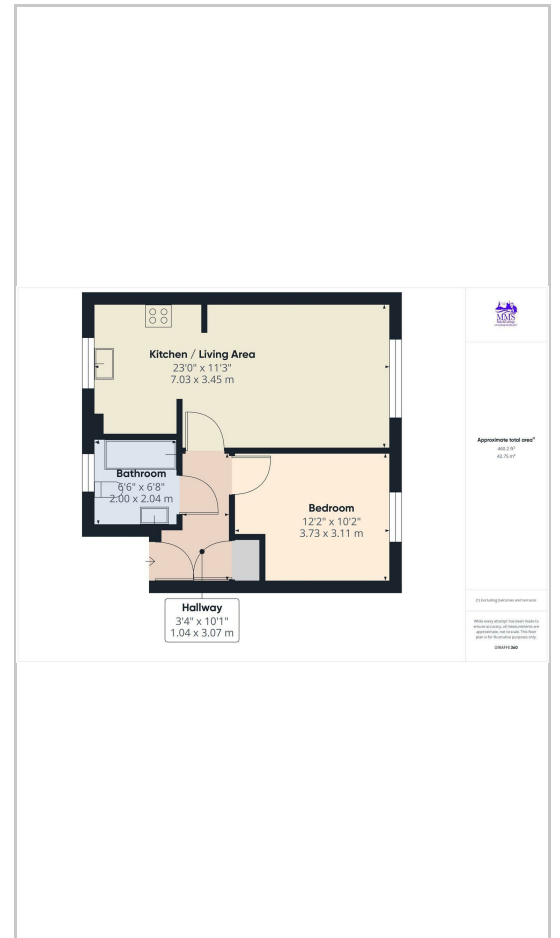

Energy Efficiency Graph

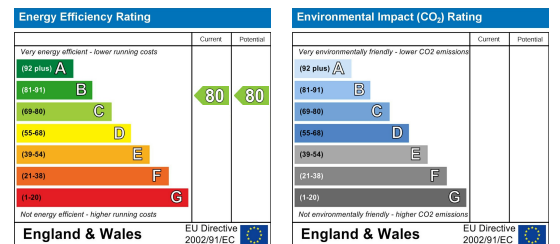

These particulars, whilst believed to be accurate are set out as a general outline only for guidance and do not constitute any part of an offer or contract. Intending purchasers should not rely on them as statements of representation of fact, but must satisfy themselves by inspection or otherwise as to their accuracy. No person in this firm's employment has the authority to make or give any representation or warranty in respect of the property.